

Petrol grass trimmer 25cm³

OPERATOR'S MANUAL

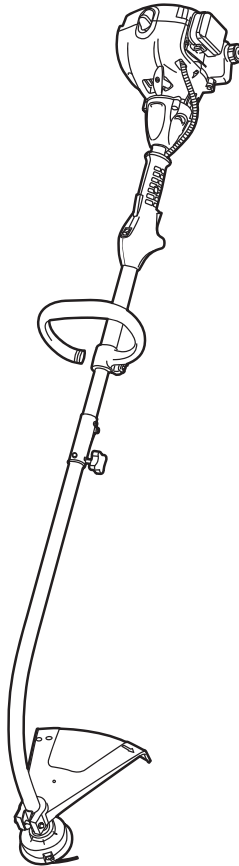

FPGTP25-2

EAN:3663602939979



WARNING: read thoroughly the instruction booklet before using the machine.

Let's begin...

These instructions are for your safety. Please read through them thoroughly before use and retain them for future reference.



Getting **started**

01

Your product	02-05
Safety Information	06-17
Before you start	18-24
Quick start	25-27



In more **detail**

28

Product functions	29-33
Operation	34-38
Care and maintenance	39-45
Troubleshooting	46
Recycling and disposal	47
Guarantee	48
CE declaration of conformity	49-52

Your product

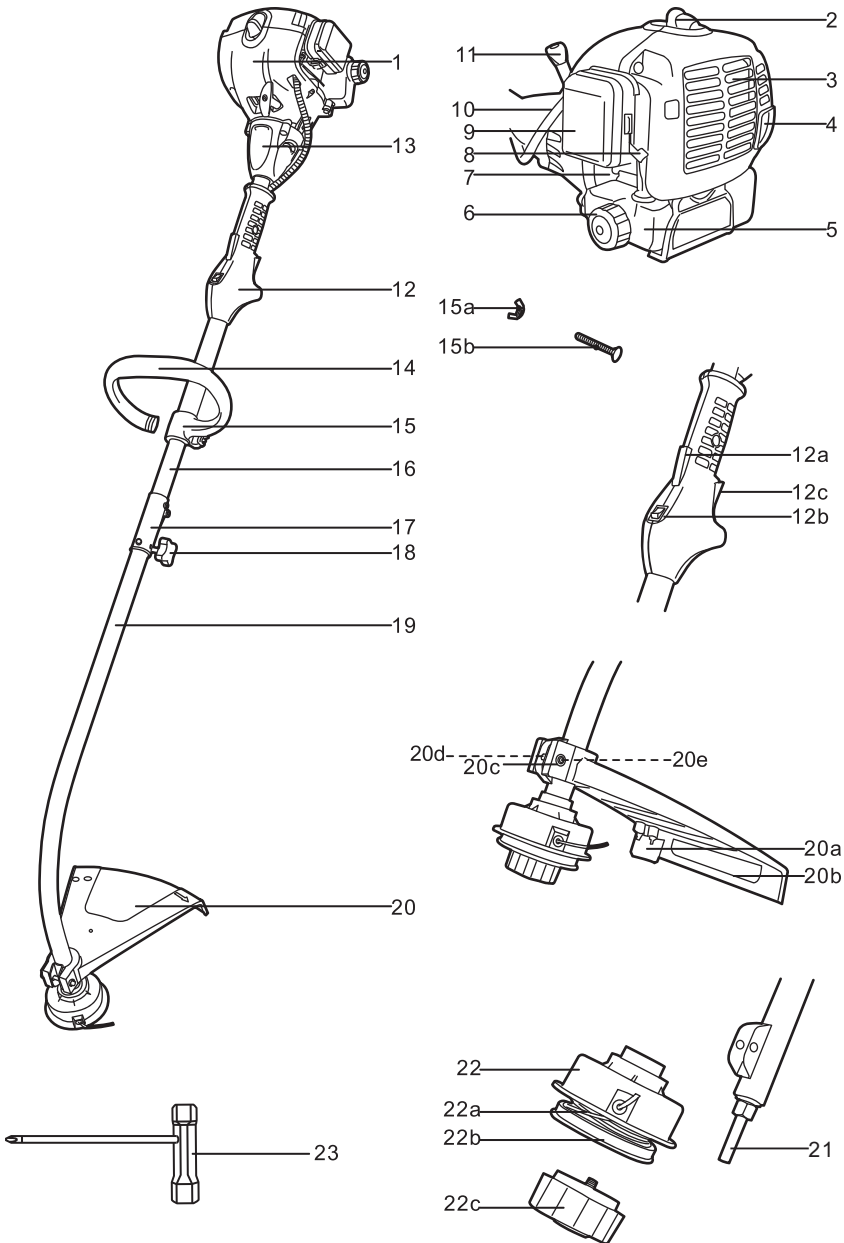

Getting started...

1. Engine
2. Spark plug connector
3. Air vents
4. Muffler
5. Fuel tank
6. Fuel tank cap
7. Primer
8. Chock lever
9. Air filter case
10. Control cable
11. Recoil starter handle
12. Control handle
 - a. Throttle interlock
 - b. Ignition switch
 - c. Throttle control
13. Clutch cover
14. Front handle
15. Bracket
 - a. Wing nut
 - b. Bolt
16. Upper shaft
17. Clamp
18. Locking knob
19. Lower shaft
20. Safety guard
 - a. Knife
 - b. Bracket
 - c. Bolt
 - d. Washer
 - e. Nut
21. Spindle
22. Trimming head
 - a. Trimming line
 - b. Spool
 - c. Bumper
23. Multi tool
Socket wrench
/ Spindle lock rod

Technical specifications

General

- > **Net weight** : 5.5 kg
- > **Fuel tank capacity** : 460 cm³
- > **Petrol type** : unleaded petrol
- > **Engine oil type** : 2-stroke engine oil
- > **Mixture ratio: petrol /oil** : 40:1
- > **Cutting line diameter** : Ø 2.0 mm
- > **Max. cutting width** : Ø 430 mm

Engine

- > **Engine model** : SL33
- > **Engine type** : air cooled 2-stroke
- > **Engine displacement** : 25 cm³
- > **Max. engine power** : 0.8 kW/7500 min⁻¹
- > **Engine idling speed** : 3000 min⁻¹
- > **Maximum rotational frequency of the spindle** : 7900 min⁻¹
- > **Fuel consumption (in accordance with ISO 8893) at max. engine performance** : 0.38 kg/h
- > **Specific fuel consumption (in accordance with to ISO 8893) at max. engine performance** : 447 g/kWh

Sound values

- > **Measured sound pressure level L_{pAav}** : 94.3 dB(A)
- > **Uncertainty K** : 3 dB(A)
- > **Measured sound power level L_{WA}** : 109.3 dB(A)
- > **Uncertainty K** : 1.91 dB(A)
- > **Guaranteed sound power level L_{WA}** : 111 dB(A)

Vibration

- > **Front handle** : 7.19 m/s²
- > **Rear handle** : 6.10 m/s²

The declared vibration value has been measured in accordance with a standard test method and may be used for comparing one tool with another. The declared vibration value may also be used in a preliminary assessment of exposure.



WARNING! The vibration emission value during actual use of the tool can differ from the declared value depending on the ways in which the tool is used. Identify safety measures to protect the operator that are based on an estimation of exposure in the actual conditions of use (taking account of all parts of the operating cycle such as the times when the tool is switched off and when it is running idle in addition to the trigger time). Depending on the actual use of the product the vibration values can differ from the declared total! Adopt proper measures to protect yourself against vibration exposures! Take the whole work process including times the product is running under no load or switched off into consideration! Proper measures include among others regular maintenance and care of the product and accessories, keeping hands warm, periodical breaks and proper planning of work processes!

The sound intensity level for the operator may exceed 85 dB(A) and ear protection measures are necessary.

Symbols

On the product, the rating label and within these instructions you will find among others the following symbols and abbreviations. Familiarise yourself with them to reduce hazards like personal injuries and damage to property.

kW	Kilowatt	cm ³	Cubic centimetre
min ⁻¹	per minute	mm	Millimetre
kg	Kilogram	dB(A)	Decibel (A-rated)
m/s ²	Metres per second		
yyWxx	Manufacturing date code, year of manufacturing (20 yy) and week of manufacturing (Wxx)		

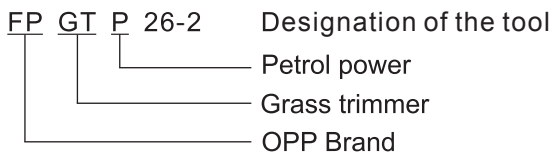

Petrol grass trimmer



Caution / Warning.



Read the instruction manual.



Wear hearing protection.
Wear eye protection.
Wear head protection, where there is a risk of falling objects.



Wear respiratory protection.



Wear face protection.



Wear protective gloves.



Wear protective footwear.



Switch the product off and disconnect the spark plug connector before assembly, cleaning, adjustments, maintenance, storage and transportation.



Do not expose the product to rain or wet conditions.



Open flames in the work area, around the product and in the vicinity of flammable materials are prohibited!



Do not smoke in the work area, around the product and in the vicinity of flammable materials!



Risk of fire / flammable materials!



Hot surface, do not touch. High temperatures on the product's surfaces and structural parts that could cause burns, if they are touched. The product can also stay hot for a longer period of time after operation!



This product produces noxious exhaust fumes. If the product is used improperly, these fumes can lead to poisoning, a loss of consciousness or death!



Only use petrol/oil mixture with a ratio of 40:1. Do not use any other mixture ratio. Always switch the product off and let it cool down, before refuelling it.



Switch the engine off while you are refilling the tanks!



Objects thrown by the product could hit the user or other bystanders. Always ensure that other people and pets remain at a safe distance from the product when it is in operation. In general, children must not come near the area where the product is.

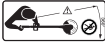

Keep other people out of working area during operation.



A distance of at least 15 m must be observed.



Inspect the area where the product is to be used and remove all objects which can be thrown by the product. If objects are hidden while operating stop the engine and remove the object.



Do not touch the cutting device until it stops completely.



Choke – CLOSE position



Choke – OPEN position



Primer



Engine manual start; Recoil starter



Use a line spool only.



Do not use metal blades.



Do not use saw blades.



Maximum rotational frequency of the shaft for the cutting attachment in min⁻¹.



Guaranteed sound power level.



The product complies with the applicable European Directives and an evaluation method of conformity for these Directives was done.



Press the primer

Safety warnings

- > This product is not intended for use by persons (including children) with reduced physical, sensory or mental capabilities, or lack of experience and knowledge, unless they have been given supervision or instruction concerning use of the product by a person responsible for their safety.
- > Children should be supervised to ensure that they do not play with the product.

Petrol powered grass trimmer safety warnings

Training

- > Read the instructions carefully. Become familiar with the instruction manual before attempting to operate the product.
- > Never allow children or people unfamiliar with these instructions to use the product. Local regulations can restrict the age of the operator.
- > Never operate while people, especially children, or pets are nearby.
- > Keep in mind that the operator or user is responsible for accidents or hazards occurring to other people or their property.
- > The product must not be used by persons under the influence of alcohol or drugs.
- > Do not operate the product without guards or if it is damaged.
- > Never use the product indoors.
- > This product produces toxic exhaust fumes when the engine is started.
- > During operation this product may generate dust, fumes and smoke containing chemicals that affect your health. So be careful when using your product and protect yourself properly.
- > Also avoid breathing exhaust fumes voluntarily; always hold the product properly during operation.
- > Wear gloves and keep hands warm.
- > Prolonged use of the product exposes the user to vibrations that can cause a range of conditions collectively known as hand-arm vibration syndrome (HAVS) e.g. fingers going white; as well as specific diseases such as carpal tunnel syndrome.

- To reduce this risk when using the product, always wear protective gloves and keep your hands warm.
- The symptoms of HAVS include any combination of the following: Tingling and numbness in the fingers; Not being able to feel things properly; Loss of strength in the hands; Fingers going white (blanching) and becoming red and painful on recovery (particularly in the cold and wet, and probably only in the tips at first). Seek medical advice immediately if such symptoms are experienced.

Preparation

- > This product can cause serious injuries. Read the instructions carefully for the correct handling, preparation, maintenance, starting and stopping of the product. Become familiar with all controls and the proper use of the product.
- > Avoid operating while people, especially children, are nearby.
- > Dress properly! Do not wear loose clothing or jewellery, which can be caught in moving parts. Use of sturdy gloves, non-skid footwear and safety glasses is recommended.
- > Use extra care when handling fuels. They are flammable and the vapours are explosive. The following points should be observed.
 - Use only an approved container.
 - Never remove the fuel cap or add fuel with the power source running. Allow engine and exhaust components to cool down before refuelling.
 - Do not smoke. Never refuel indoors.
 - Never store the product or fuel container inside where there is an open flame, such as near a water heater.
 - If fuel is spilled, do not attempt to start the power source, but move the product away from the spillage before starting. Move product at least 3 m (10 feet) away from place used for refuelling.
 - Always replace and securely tighten the fuel cap after refuelling.
 - If the fuel tank is drained, this should be done outdoors.

- > Store the product in a dry, clean place protected from direct sunlight only after the fuel tank has been emptied and the product is cleaned. The product must be stored inside only under these conditions.
- > If the cutting attachment strikes any foreign object or the product starts making any unusual noise or vibration, shut off the power source and allow the product to stop. Disconnect the spark plug connector from the spark plug and take the following steps:
 - inspect for damage,
 - check for, and tighten, any loose parts,
 - have any damaged parts replaced or repaired with parts having equivalent specifications.

Operation

- > This product should not be used for any other purpose than described. National regulations can restrict the use of the product.
- > While operating, always wear substantial footwear and long trousers. Do not operate the product when barefoot or wearing open sandals. Wear protective glasses or goggles.
- > Ensure the area to be worked is clear from stones, sticks, wire etc. or other objects that could damage the product.
- > Thoroughly inspect the area where the product is to be used and remove all objects which can be thrown by the product.
- > Before using the product and after any impact, check for signs of wear or damage and repair as necessary.
- > Never operate the product with damaged guards or without the guards in place.
- > Keep hands and feet away from the cutting attachment at all times and especially when switching on the engine.
- > Never allow children or people unfamiliar with the instructions to use the product.
- > Stop using the product while people, especially children, or pets are nearby.

- > Only use the product in daylight or good artificial light.
- > Keep your body upright during operation. Do not lean forward. Make regular breaks and change your working position to stay concentrated.
- > Keep firm footing and balance during operation. Always use the harness, if provided.
- > Stop the engine before
 - cleaning or when clearing a blockage,
 - checking, carrying out maintenance or working on the product,
 - adjusting the working position of the cutting attachment,
 - leaving the product unattended.
- > Ensure that the product is correctly located in a designated working position before starting the engine.
- > While operating the product, always ensure that the operating position is safe and secure.
- > Do not operate the product with a damaged or worn cutting attachment.
- > Keep the engine and silencer free of debris, leaves and excessive lubricant to reduce fire hazards.
- > Always ensure that all handles and guards are fitted when using the product. Never attempt to use an incomplete product or one fitted with an unauthorised modification.
- > Always use two hands to operate a product fitted with two handles.
- > Always be aware of your surroundings and stay alert for possible hazards of which you may not be aware due to the noise of the product.
- > Be careful when handling any cutting attachment / sharp edge fitted for trimming the filament line length. Ensure a new filament trimming line is installed correctly before turning the product on.
- > Always ensure that air vents are kept clear of debris.
- > Only use cutting attachments as listed in the technical data within these instructions. The use of other attachments leads to hazards resulting in personal injuries and damage to property.

- > Never carelessly touch the product, you can burn yourself. While the product is in operation or shortly thereafter, its parts such as the exhaust pipe, engine, and other surfaces are extremely hot! Pay attention to the markings on the product.

Maintenance and storage

- > Follow the maintenance and repair instructions for this product. Never carry out any modifications of the product.
- > Never change the preset rotary speed or the engine and product settings. Information about maintenance and repair is provided in this user manual.
- > When the product is stopped for servicing, inspection or storage, shut off the power source, disconnect the spark plug connector from the spark plug and make sure all moving parts have come to a stop. Allow the product to cool before making any inspections, adjustments, etc.
- > Inspect the product before each use, after dropping the product or exposing to other impacts to identify significant defects.
- > Store the product where the fuel vapour will not reach an open flame or spark. Always allow the product to cool down before storing.
- > When not in use store the product out of the reach of children.
- > Use only manufacturers recommended replacement parts and accessories.
- > Secure the product during transport to prevent loss of fuel, damage and injury.
- > Clean and maintain the product as described in these instructions before storage. Always use guards on cutting attachments when storing.
- > Make sure that the air intake of the combustion engine is clear. Keep the air intake free of dust, dirt particles, gases and fumes.
- > Make sure that air circulation is adequate and good. The product must be easily accessible from all sides.

Fuel handling

- > Always switch the product off and let it cool down, before refuelling it. Petrol is highly flammable. Never smoke when you are refuelling the product. Do not refuel the product, if there is an open fire in the vicinity!
- > Always use suitable aids such as funnels and filler necks. Do not spill any fuel on the product or its exhaust system. There is a risk of ignition. However, if fuel should be spilled, then you must remove it carefully from all parts of the product. Any residue which may be present must be completely removed, before the product is operated!
- > Exhaust gases and fuel fumes are noxious. Fuel fumes can ignite. Never use the product in environments where there is a risk of explosion.
- > Never breathe in any fuel fumes, when you are refuelling the product. Never fill the tank in enclosed spaces, such as basements or sheds. There is a risk of poisoning and explosion!
- > Avoid skin contact with petrol.
- > Do not eat or drink, while you are refuelling the product. If you have swallowed petrol or oil, or if petrol or oil has got into your eyes, then seek medical advice immediately.
- > Close the tank lid immediately after filling the tank. Make sure that it is properly closed.
- > Never use the product without an air filter.

Vibration and noise reduction

To reduce the impact of noise and vibration emission, limit the time of operation, use low-vibration and low-noise operating modes as well as wear personal protective equipment.

Take the following points into account to minimize the vibration and noise exposure risks:

- > Only use the product as intended by its design and these instructions.
- > Ensure that the product is in good condition and well maintained.
- > Use correct application tools for the product and ensure they in good condition.

- > Keep tight grip on the handles/gripping surface.
- > Maintain this product in accordance with these instructions and keep it well lubricated (where appropriate).
- > Plan your work schedule to spread any high vibration tool use across a longer period of time.

Emergency

Familiarise yourself with the use of this product by means of this instruction manual. Memorise the safety directions and follow them to the letter. This will help to prevent risks and hazards.

- > **Always be alert when using this product, so that you can recognise and handle risks early.** Fast intervention can prevent serious injury and damage to property.
- > **Stop the engine and disconnect the spark plug connector if there are malfunctions.** Have the product checked by a qualified professional and repaired, if necessary, before you operate it again.
- > **In case of fire stop the engine and disconnect the spark plug connector.** Take fire-extinguishing measures immediately if the product switch is no longer accessible.



WARNING! Never use water to extinguish a product on fire. Burning fuel must be extinguished with special extinguishing agents! We recommend that you keep a suitable fire extinguisher within reach in your work area!

Residual risks

Even if you are operating this product in accordance with all the safety requirements, potential risks of injury and damage remain. The following dangers can arise in connection with the structure and design of this product:

- > Health defects resulting from vibration emission if the product is being used over long periods of time or not adequately managed and properly maintained.
- > Injuries and damage to property due to broken application tools or the sudden impact of hidden objects during use.

- > Danger of injury and property damage caused by flying objects.
- > Burns, if touching hot surfaces.



WARNING! This product produces an electromagnetic field during operation! This field may under some circumstances interfere with active or passive medical implants! To reduce the risk of serious or fatal injury, we recommend persons with medical implants to consult their doctor and the medical implant manufacturer before operating this product!

Unpacking

- > Unpack all parts and lay them on a flat, stable surface.
- > Remove all packing materials and shipping devices if applicable.
- > Make sure the delivery contents are complete and free of any damage. If you find that parts are missing or show damage do not use the product but contact your dealer. Using an incomplete or damaged product represents a hazard to people and property.
- > Ensure that you have all the accessories and tools needed for assembly and operation. This also includes suitable personal protective equipment.

You will need

(items not supplied)

- unleaded petrol
- 2-stroke engine oil
- Fuel funnel with filter
- Suitable personal protective equipment
- Suitable container for petrol and 2-stroke engine oil mixing

(items supplied)

- Multi tool

Assembly



WARNING! The product must be fully assembled before operation! Do not use a product that is only partly assembled or assembled with damaged parts! Follow the assembly instructions step-by-step and use the pictures provided as a visual guide to easily assemble the product!

Disconnect the spark plug connector (2) from the spark plug!



NOTE: Take care of small parts that are removed during assembly or when making adjustments. Keep them secure to avoid loss.

Auxiliary handle assembly

- > Loosen and remove the preassembled bolt (15b) and wing nut (15a) from the auxiliary handle (14) (Fig. 1a).

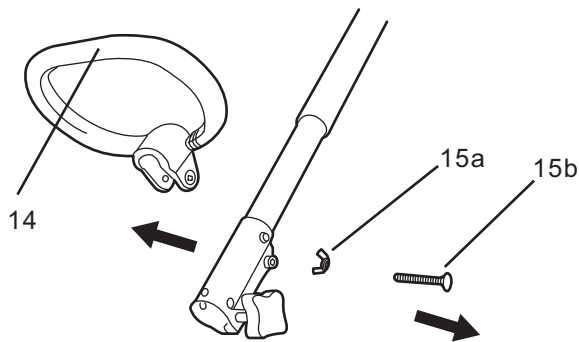

Fig. 1a

- > Place the auxiliary handle (14) onto the upper shaft (16) and secure it with the bolt (15b) and wing nut (15a) (Fig. 1b)

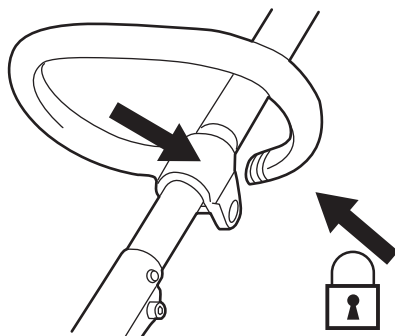

Fig. 1b

Shaft assembly

- > Align the lower shaft (19) with the clamp (17) so that the safety pin (Fig. 2a, A) is orientated to the middle hole in the clamp.
- > Press the safety pin down and insert the lower shaft (19) into the clamp (17) (Fig. 2a).

- > Release the safety pin; ensure that it engages in the hole on the upper shaft (Fig. 2b).

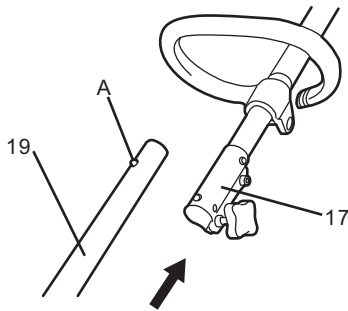

Fig. 2a

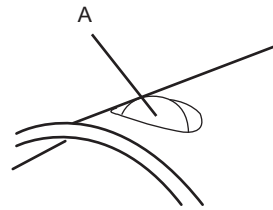

Fig. 2b

- > Tighten the locking knob [18] anticlockwise to secure the connection (Fig. 2c).

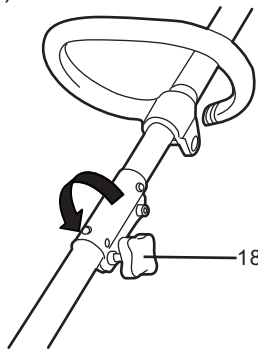

Fig. 2c

Safety guard assembly

- > Loosen the pre-assembled bolt (20c) and remove it together with the washer (20d) and nut (20e) from the bracket (20b).
- > Place the safety guard (20) with the bracket (20b) onto the support on the lower shaft (Fig. 3).
- > Secure the safety guard (20) with the bolt (20c), washer (20d) and nut (20e). Tighten the bolt properly.

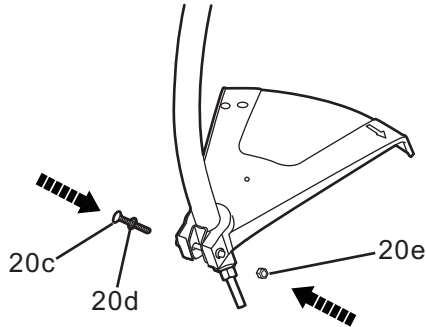

Fig. 3

Trimming head

- > Make sure that the safety guard (20) has been attached properly.
- > Slide the trimming head (22) onto the spindle (21) (Fig. 4).

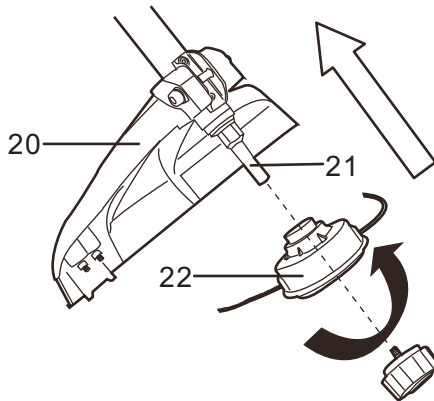

Fig. 4

- > Screw the bumper (22c) clockwise to secure the trimming head.

Fuel



WARNING! This product is not supplied with fuel-oil mixture in the engine! Before operating this product it is essential to fill it with fuel-oil mixture!



40:1



- > This product is equipped with a 2-stroke engine, the fuel and oil tank are combined and it is essential to fill a fuel-oil mixture before operating this product. Observe the technical specifications for suitable fuel and engine oil.



WARNING! Fuel and oil are highly inflammable! Fumes will explode if lit! Ensure that there are no naked flames around the product! Do not smoke while filling fuel and oil!



- > Place the product on a stable, level surface with the fuel tank cap (6) facing upward. We recommend laying a non-flammable sheet under the product.
- > Mix a regular-grade unleaded petrol and a quality engine oil for air cooled 2-stroke engines in a suitable container (Fig. 5a).



NOTE: Use an anti-oxidant added quality oil expressly labelled for air-cooled 2 stroke engine use (JASO FC GRADE OIL or ISO EGC GRADE). Do not use BIA or TWC (2 stroke water-cooling type) mixed oil. The recommended mixing ratio for petrol:oil is 40:1.



NOTE: Never mix fuel and oil directly in the tank of the product.

Petrol [ml]	Oil [ml]
100	2,5
200	5,0
300	7,5
400	10,0
500	12,5



Fig. 5a

- > Unscrew and remove the fuel tank cap (6).

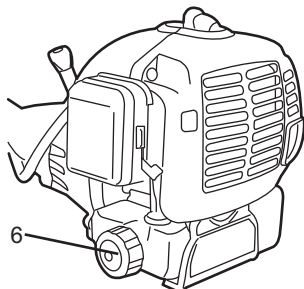

Fig.5b

- > Fill correctly mixed fuel/oil into the tank using a fuel funnel fitted with a filter to avoid debris entering the tank. Do not overfill and leave approximately 5 mm of space between the top of the fuel and the inside edge of the tank to allow for expansion (Fig. 5c).
- > Avoid spilling and overfilling the tanks.

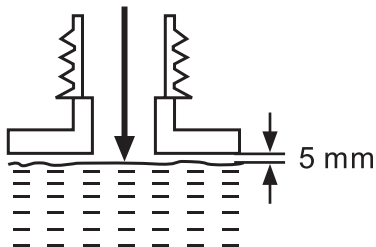

Fig.5c



NOTE: Fuel deteriorate over time. It may be difficult to start the engine if you use fuel which has been kept for more than 30 days.

Towards the end of the season, it is advisable to put only as much fuel in the tank as you need for each use, since it should be completely used up before storing the product. Empty remaining fuel from the tank when storing the product for over 30 days

- > Wipe up spilled fuel with a soft cloth and refit the fuel tank cap (6). Tighten the cap properly (Fig. 5b).



NOTE: Always dispose of fuel, used oil and objects contaminated with them in accordance with local regulations.

Operating controls

Getting started...

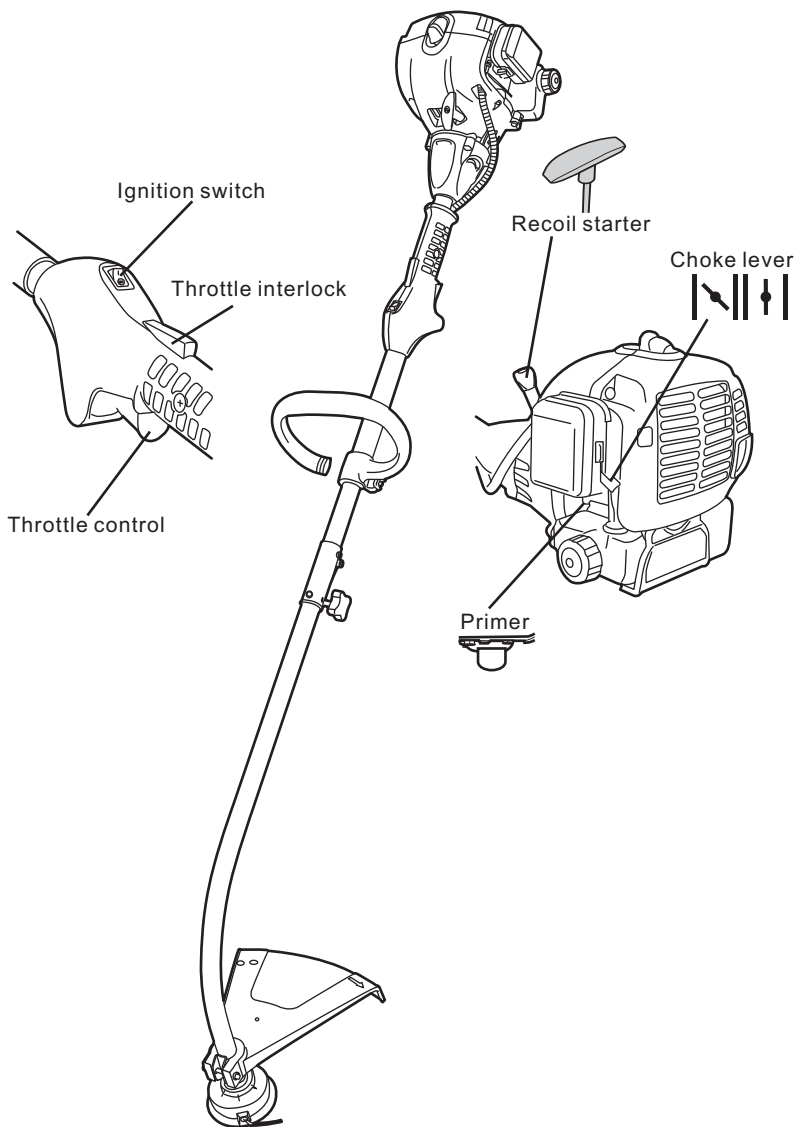

Set up



Assemble



Adjust



Add oil mixture

Cold start

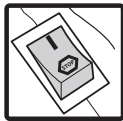

Set ignition switch to "I"



Press primer until fuel is visible

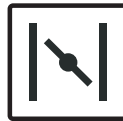

Close choke



Press throttle control and interlock



Pull recoil starter handle

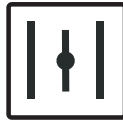

Open choke



Run idle



Operate

Warm start

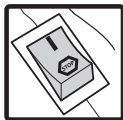

Set ignition switch to "I"

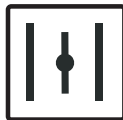

Open choke



Press throttle control and interlock



Pull recoil starter handle



Run idle



Operate

Stopping



Release throttle control and interlock



Run idle

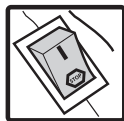

Set ignition switch to "O"



Empty fuel tank



Maintain



Store



WARNING! This quick start provides only a short overview of how to start and stop the product! For safe use it is essential to read the entire instruction manual before first use!



In more detail ...

Product functions	29-33
Operation	34-38
Care and maintenance	39-45
Troubleshooting	46
Recycling and disposal	47
Guarantee	48
CE declaration of conformity	49

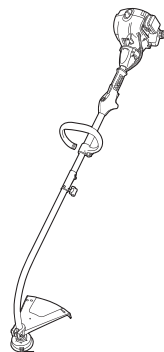

Intended use

- > This petrol grass trimmer FPGTP25-2 is designated with a rated input of 0.8kW.
- > This product is intended to cut smaller types of weed, lawn grass or similar soft vegetation.
- > The product should not be used to cut unusually thick grass or vegetation, wet grass or to shred leaves etc.
- > For safety reasons it is essential to read the entire instruction manual before first operation and to observe all the instructions therein.
- > This product is intended for private domestic use only, not for any commercial trade use. It must not be used for any purposes other than those described.

Primer

Use the primer (7) when starting the product with cold engine (Fig. 6).

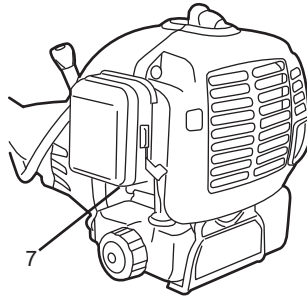

Fig. 6

Recoil starter

- > The recoil starter handle (11) is positioned at the front of the engine.
- > Pull on the recoil starter handle (11) to start the engine (Fig. 7).

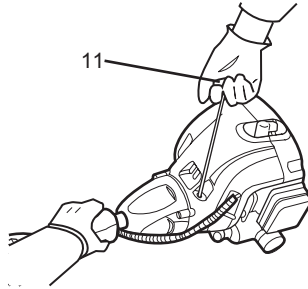

Fig.7



WARNING! Never twist the starter cord around your hand! Only pull on the handle!



WARNING! Do not suddenly release the recoil starter handle! Allow the rope to return slowly and in a controlled manner each time it is pulled! Do not pull out the recoil starter beyond the red colour band at the end of the recoil starter!

Hand grip controls

There are three controls at the control handle with the following functions (Fig. 8):

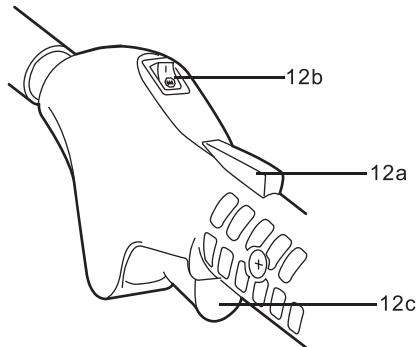

Fig.8

- > The ignition switch (12b) electrically starts or stops the engine.
- > The throttle interlock (12a) prevents unintentional activation of the throttle control.
- > Adjust the engine speed with the throttle control (12c).

Adjustable auxiliary handle

Adjust the height of the front handle (14).

- > Loosen the wing nut (15a) on the auxiliary handle (14) and adjust the height (Fig. 9).

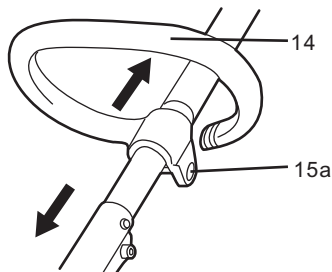

Fig.9

- > Afterward tighten the wing nut (15a).

Trimming head

The trimming head (22) is intended to cut smaller types of weed, lawn grass or similar soft vegetation.

- > The trimming head is equipped with a bumper (22c) helping to release and cut the trimming line (22a). Simply tap the bumper on a firm surface and the spool will release fresh trimming line (Fig. 10a).

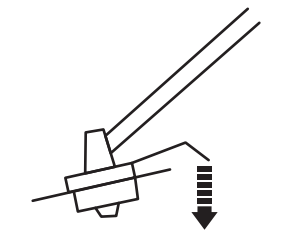

Fig.10a

- > An integrated knife (20a) will cut the line to the necessary length.



WARNING! The cut trimming line will be thrown out!
Danger of injury especially for bystanders!

Angle adjustment

- > The angle of trimmer head can be adjusted according to the performed work.
- > Press the safety pin down and rotate the lower shaft either to the right or left side until the safety pin engages in the respective hole.



WARNING! Always ensure the safety pin is properly engaged! Otherwise do not operate the product!

- > Adjust to 90° when trimming grass on the flat ground (Fig. 10).

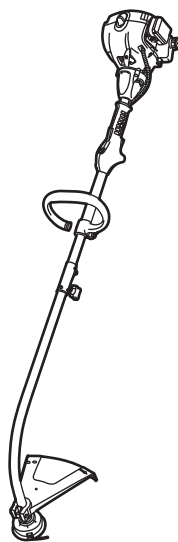

Fig.10

Safety guard

- > The safety guard protects the operator against thrown objects during operation.
- > The safety guard is equipped with a knife (20a) that cuts the trimming line if required (Fig. 11).

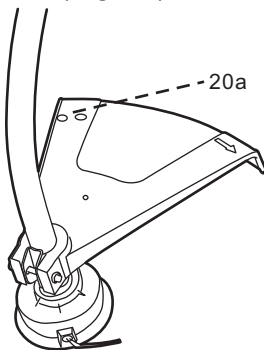

Fig. 11



NOTE: Always remove the knife protection before use.

Carburettor

The carburettor is pre-set by the manufacturer. Should it be necessary to make any changes please contact an authorised service centre or a similarly qualified person. Do not attempt to make any adjustments by yourself.

General operation

- > Check the product as well as accessories for damage before each use. Do not use the product if it is damaged or shows wear.
- > Double check that accessories or application tools are properly fixed.
- > Check the fuel level, refill if necessary.
- > Always hold the product on its handles. Keep the handles dry to ensure safe support.
- > Ensure that the air vents are always unobstructed and clear. Clean them if necessary with a soft brush. Blocked air vents may lead to overheating and damage the product.
- > Switch the product off immediately if you are disturbed while working by other people entering the working area. Always let the product come to complete stop before putting it down.
- > Do not overwork yourself. Take regular breaks to ensure you can concentrate on the work and have full control over the product.

Starting/Stopping

Cold Start

- > Place the product on a flat, stable surface. Ensure that the cutting attachment does not touch the ground or any objects.
- > Set the ignition switch (12b) to the "I" position (Fig. 12a).
- > Depress the primer (7) until fuel is visible and move the choke lever (8) to its "CLOSE" position (Fig. 12b).
- > Press the throttle interlock [12a] and throttle control (12c), hold them in position.
- > Hold the product stable and pull the recoil starter handle(11) slowly until you feel a definite resistance (starter engaged) and then give it a brisk, strong pull. Repeat until the engine starts. (**Note:** If the engine cannot start, pull the choke lever downward to "OPEN" position and repeat this step until the engine starts.) (Fig. 12c).
- > Release the throttle interlock (12a) and throttle control (12c)

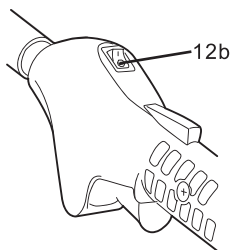

Fig. 12a

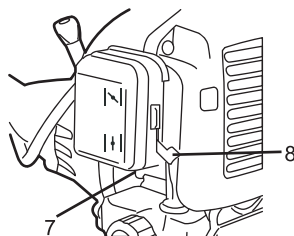

Fig. 12b

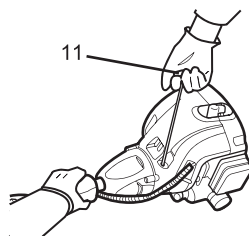

Fig. 12c

- > Move the choke lever [8] to its “I” position.
- > Allow the engine to warm up for a few minutes in idling speed.



WARNING! The cutting attachment should not move during idling speed! If you find that the cutting attachment is moving, stop using the product and have it inspected and adjusted by an authorised service centre or a similarly qualified person!

- > Once the engine is running correctly, carefully lift the product and hold it firmly with both hands on both handles.
- > Press the throttle interlock [12a] and throttle control [12c] to engage the cutting attachment.

Warm start

- > Set the ignition switch (12b) to the “I” position (Fig. 12a).
- > Do not prime and move the choke lever (8) to its “I” position (Fig. 12b).
- > Press the throttle interlock (12a) and throttle control (12c), hold them in position.
- > Hold the product stable and pull the recoil starter handle(11) slowly until you feel a definite resistance (starter engaged) and then give it a brisk, strong pull. Repeat until the engine starts. (Fig. 12c).
- > Release the throttle interlock (12a) and throttle control (12c).
- > Once the engine is running correctly, carefully lift the product and hold it firmly with both hands on both handles.
- > Press the throttle interlock (12a) and throttle control (12c) to engage the cutting attachment.

Stopping

- > Release the throttle interlock (12a) and throttle control (12c) and let the product to run at its idle speed for 10 – 15 seconds (Fig. 13).
- > Set the ignition switch [12b] to “STOP” position to switch engine off.

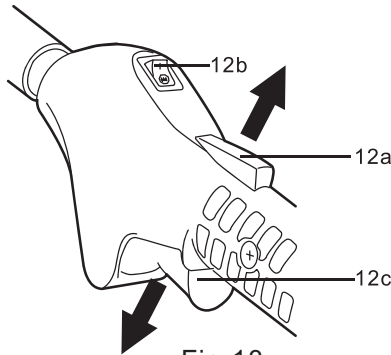

Fig.13

Trimming

- > The trimming head is intended to cut smaller types of weed, lawn grass or similar soft vegetation.
- > Hold the product firmly so that it sits with a gap between the product and your right side.
- > Stand upright, do not lean forward and pay attention to posture. Keep both feet apart to help retain your balance.
- > Hold the cutting head just above the ground at an angle of approximately 30° (Fig. 14a).
- > Move the product with a slow regular arc from left to right before moving it back to the starting position before trimming the next area (Fig. 14b).

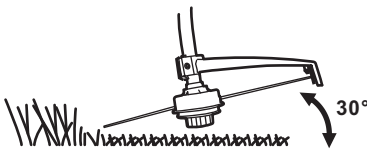

Fig.14a

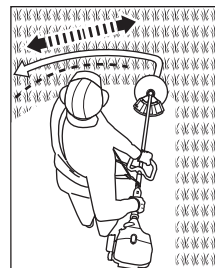

Fig.14b

- > Ensure the cutting attachment remains clean and free from off-cuts that may cause it to jam. Check regularly. Stop the engine, set the ignition switch (12b) to “STOP” and disconnect the spark plug connector (2) before checking.
- > Trim longer grass in stages; do not cut long grass in one cut (Fig. 14c). For the best results, cut longer grass in steps (Fig. 14d).

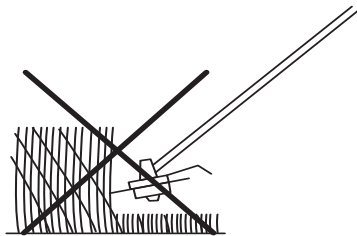

Fig. 14c

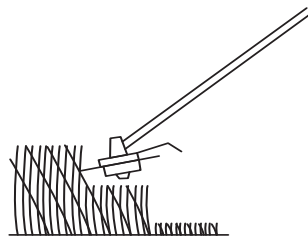

Fig. 14d

- > Tap the bumper on solid ground to feed the trimming line if it's worn-out or ripped.

Tips

- > For best results, do not cut wet grass because it tends to stick to the cutting attachments and guard, prevents proper discharge of grass trimmings, and could cause you to slip and fall.
- > Pay special attention when performing the work close to trees and bushes. The cutting attachment could damage sensitive bark, and damage fence posts (Fig. 15).

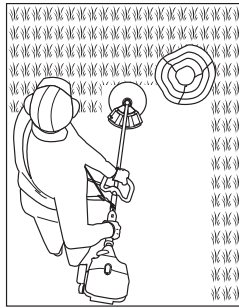

Fig. 15

After use

- > Switch the product off, disconnect the spark plug connector and let it cool down.
- > Check, clean and store the product as shown below.

The golden rules for care



WARNING! Always switch the product off, disconnect the spark plug connector and let the product cool down before performing inspection, maintenance and cleaning work!



- > Keep the product clean. Remove debris from it after each use and before storage.
- > Regular and proper cleaning will help ensure safe use and prolong the life of the product.
- > Inspect the product before each use for worn and damaged parts. Do not operate it if you find broken and worn parts.



WARNING! Only perform repairs and maintenance work according to these instructions! All further works must be performed by a qualified specialist!

General cleaning

- > Clean the product with a slightly damp cloth and mild soap. Use a brush for areas that are hard to reach.
- > In particular clean the air vents (3) after every use with a cloth and brush.
- > Remove stubborn dirt with high pressure air (max. 3 bar).



NOTE: Do not use chemical, alkaline, abrasive or other aggressive detergents or disinfectants to clean this product as they might be harmful to its surfaces.

- > Check for any damage and wear. Repair damages in accordance with this instruction manual or take it to an authorised service centre before using the product again.

Maintenance table

Inspect and maintain this product regularly based on below maintenance table.

Part	To do	Before/ after each use	10 hours	25 hours	50 hours / half year	100 hours / once a year
Air filter	clean		X			
Spark plug	check			X		
Spark plug	clean			X		
Spark plug	replace	whenever necessary				
Air filter	check	X				
Air filter	clean		X			
Air filter	replace	whenever necessary				
Fuel filter	check	X				
Fuel filter	clean		X			
Fuel filter	replace	whenever necessary				

Cutting attachment and safety guard

- > Keep the cutting attachment and the safety guard clean and free of debris. Remove grass trimmings.



WARNING! Wear safety gloves when working on the cutting attachment. Use appropriate tools to remove debris e.g. a brush or wooden stick! Never use your bare hands!

- > Replace worn or damaged spools and refill the trimming line with new ones of the same type (refer to “**Assembly – Trimming head**” for detailed instructions how to remove and attach them).

Spool

- > If the line is used up the spool must either be replaced by one of the same type or the trimming line (22a) must be refilled.



WARNING! Only replace spool and/or trimming line according to the technical specifications (see *You product – Technical specification*)!
Never use metal thread!
Always use cutting attachments in perfect condition, free of damage!

- > Lay the product on a flat stable surface with the trimming head facing upward.
- > Remove the trimming head (22) by unscrewing the bumper clockwise (Fig. 16a).
- > Twist the spool (22b) slightly to open the trimming head housing. The cover and spool will pop out (Fig. 16b).

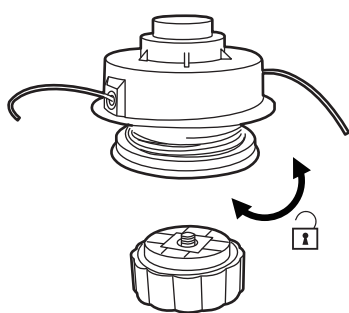

Fig. 16a

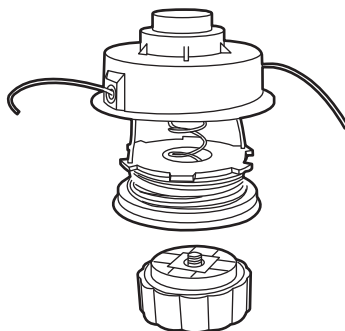

Fig. 16b

Replacing the spool

- > Remove the worn spool and replace with a new one of the same type.
- > Align the noses on the spool to the notches of the housing, and then push and twist the spool onto the housing to close the trimming head.

Refilling trimming line

- > Cut a new trimming line. Form a loop at the middle of the line and insert this loop into the hook on the spool (Fig. 16c).
- > Wind the two parts of the trimming line in clockwise direction firmly around the spool. Ensure each part of the line is either side of the guide on the spool (Fig. 16d).

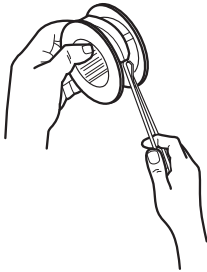

Fig.16c

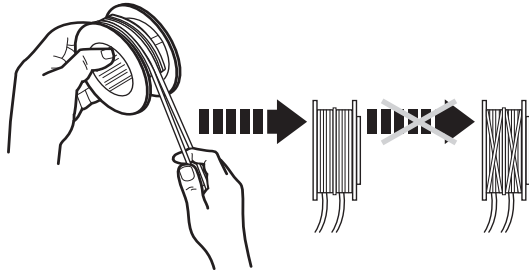

Fig.16d

- > Insert each end of the trimming line in the respective holes. The line should stick out 200mm on each side.
- > Refit the trimming head to the spindle as described in section “**Assembly – Trimming head**”.



WARNING! After changing the trimming line, run the product under no load for at least a minute to make sure that the line and the product are operating correctly!

Air filter

Inspect the air filter regularly. Clean or replace with a new one if necessary.

- > Press the latch (B) and remove the cover (A) from the air filter case (9) (Figs. 17a, 17b).

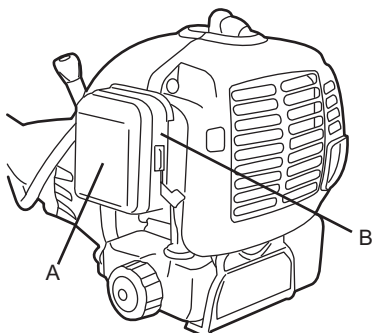

Fig.17a

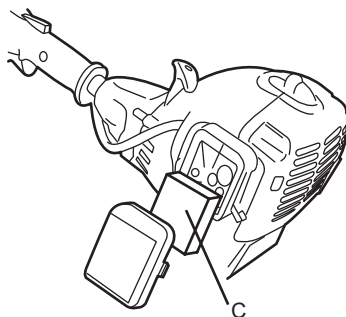

Fig.17b

- > Remove the air filter (C).
- > Tap the filter on a firm surface to remove dust. Use high pressure air (max. 3 bar) to remove stubborn dust.
- > Apply a small amount of air filter oil on the filter to increase the filter performance. Wring out surplus oil and put the filter into the case (9).
- > Attach the cover (A); ensure its latch (B) snaps in place.

Spark plug

Inspect the spark plug regularly. Clean or replace with a new one if necessary.

- > Disconnect the spark plug connector (2).
- > Loosen the spark plug with the multi tool (23) as spark plug wrench and carefully remove it.
- > Check the spark plug for damage and wear. The colour of the electrode should be light-brown coloured.
- > Remove debris from the electrode with a soft wired brush; avoid heavy cleaning of the electrode.
- > Dry the spark plug with a soft cloth if it is wet from fuel.
- > Check the spark plug gap. It should be 0.6 – 0.7 mm (Fig. 18).

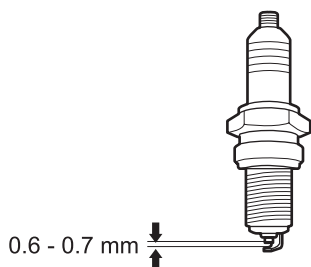

Fig.18

- > Replace with a new spark plug if either the electrode or the insulation is damaged.
- > When replacing the spark plug, first screw it in hand tight and then lightly tighten it with the spark plug wrench.



WARNING! Do not over tighten the spark plug to avoid any damage!

Fuel tank

- > Empty the fuel tank when storing the product over 30 days to prevent the fuel deteriorating.
- > Unscrew and remove the fuel tank cap [6] and use a proper fuel pump to empty the fuel into a suitable container.

Fuel filter

The fuel tank of this product is fitted with a filter located at the free end of the fuel pipe. If it be necessary to clean or replace the fuel filter, please contact an authorised service centre or a similarly qualified person.

Carburettor

The carburettor is pre-set by the manufacturer. Should it be necessary to make any changes please contact an authorised service centre or a similarly qualified person. Do not attempt to make any adjustments by yourself.

Muffler

If it be necessary to modify or replace the muffler, please contact an authorised service centre or a similarly qualified person.

Repair

This product does not contain any parts that can be repaired by the consumer. Contact an authorised service centre or a similarly qualified person to have it checked and repaired.

Storage

- > Clean the product as described above.
- > Store the product and its accessories in a dry, frost-free place.
- > Always store the product in a place that is inaccessible to children. The ideal storage temperature is between 10 and 30°C.
- > We recommend using the original package for storage or covering the product with a suitable cloth or enclosure to protect it against dust.
- > Empty the tank if you are not going to use the product for an extended period of time (more than 3 months) and before storing it for the winter.

Transportation

- > Switch the product off and disconnect the spark plug connector before transporting it anywhere.
- > Attach transportation guards, if applicable.
- > Always carry the product by its handles.
- > Protect the product from any heavy impact or strong vibrations which may occur during transportation in vehicles.
- > Secure the product to prevent it from slipping or falling over, loss of fuel, damage and injury.

Troubleshooting



WARNING! Only perform the steps described within these instructions! All further inspection, maintenance and repair work must be performed by an authorised service centre or a similarly qualified specialist if you cannot solve the problem yourself!

Problem	Possible cause	Solution
Engine does not start	Not enough fuel in fuel tank	Add fuel
	Primer has been not pressed at cold start	Press the primer and restart
	Primer has been pressed at warm start	Dry spark plug
	Spark plug is wet	Dry spark plug
	Spark plug is damaged	Replace spark plug
	Spark plug connector loose	Attach properly
Engine stops	Not enough fuel in fuel tank	Add fuel
	Cutting attachment is blocked	Remove blockage
Unsatisfactory result	Cutting attachment blunt	Sharpen or replace the cutting attachment
Excessive vibration/noise or exhaust	Cutting attachment is dull/damaged	Replace with a new one
	Bolts/nuts are loosen	Tighten bolts/nuts
	Petrol/oil is incorrect	Empty out unused petrol/oil and refill with the correct petrol/oil

In more detail...

Recycling and disposal

- > Petrol, oil, used oil, mixtures of oil and petrol and objects contaminated with oil, e.g. cleaning cloths; do not belong with household waste. Dispose of oil-contaminated items in accordance with the local guidelines and hand them in at recycling centres.
- > The product comes in a package that protects it against damages during shipping. Keep the package until you are sure that all parts have been delivered and the product is function properly. Recycle the package afterwards.

Guarantee

We take special care to select high quality materials and use manufacturing techniques that allow us to create products incorporating design and durability. This product has a manufacturer's guarantee of 2 years against manufacturing defects, from the date of purchase (if bought in store) or date of delivery (if bought online), at no additional cost for normal (non-professional or commercial) household use.

To make a claim under this guarantee, you must present your proof of purchase (such as a sales receipt, purchase invoice or other evidence admissible under applicable law), please keep your proof of purchase in a safe place. For this guarantee to apply, the product you purchased must be new, it will not apply to second hand or display products. Unless stated otherwise by applicable law, any replacement product issued under this guarantee will only be guaranteed until expiry of the original period guarantee period.

This guarantee covers product failures and malfunctions provided the product was used for the purpose for which it is intended and subject to installation, cleaning, care and maintenance in accordance with the information contained in these terms and conditions, in the user manual and standard practice, provided that standard practice does not conflict with the user manual.

This guarantee does not cover defects and damage caused by normal wear and tear or damage that could be the result of improper use, faulty installation or assembly, neglect, accident, misuse, or modification of the product. Unless stated otherwise by applicable law, this guarantee will not cover, in any case, ancillary costs (shipping, movement, costs of uninstalling and reinstalling, labour etc), or direct and indirect damage.

Rights under this guarantee are enforceable in the country in which you purchased this product. Guarantee related queries should be addressed to the store you purchased this product from. The guarantee is in addition to and does not affect your statutory rights.

For after sales
help and advice,
please call

cs@b-gr8.co.uk

HELPLINE

0333 2000 339

In more detail...



(EN) EU DECLARATION OF CONFORMITY
 (FR) DÉCLARATION UE DE CONFORMITÉ
 (PL) DEKLARACJA ZGODNOŚCI UE
 (RO) DECLARAȚIA DE CONFORMITATE UE
 (ES) DECLARACIÓN UE DE CONFORMIDAD
 (PT) DECLARAÇÃO DE CONFORMIDADE UE

Product/ Produit/ Produkt/Produsul/Producto/Producto

- > Petrol grass trimmer/Coupe-bordure thermique/Spalinowapodkaszarka do trawy/Masina de tuns iarba cu petrol/Bordeadora de gasolina para cesped/Aparador de relva a gasolina
- > FPGTP25-2
- > 25 cm³ , 0.8 kW
- > 000001 - 999999

Name and address of the manufacturer or his authorised representative:

Nom et adresse du fabricant ou de son mandataire :

Nazwa i adres producenta lub jego upoważnionego przedstawiciela:

Denumirea și adresa producătorului sau a reprezentantului său autorizat:

Nombre y dirección del fabricante o de su representante autorizado:

Nome e endereço do fabricante ou do respetivo mandatário:

Kingfisher International Products B.V.,
 Rapenburgerstraat 175E,
 1011 VM Amsterdam,
 The Netherlands
www.kingfisher.com/products

This declaration of conformity is issued under the sole responsibility of the manufacturer.

La présente déclaration de conformité est établie sous la seule responsabilité du fabricant.

Niniejsza deklaracja zgodności wydana zostaje na wyłączną odpowiedzialność producenta.

Prezenta declarație de conformitate este emisă pe răspunderea exclusivă a producătorului.

La presente declaración de conformidad se expide bajo la exclusiva responsabilidad del fabricante.

A presente declaração de conformidade é emitida sob a exclusiva responsabilidade do fabricante.

Object of the declaration/Objet de la déclaration/Przedmiot deklaracji/Obiectul declarației/Objeto de la declaración/Objeto da declaração

**Product/Produit/Produkt/Produsul/
 Producto/Producto**

**Model/Modèle/Model/
 Modelul/Modelo/Modelo**

EAN

Petrolgrasstrimmer/Coupe-bordure thermique/
 Spalinow a podkaszarka do trawy/Masina de tuns
 iarba cu petrol/Bordeadora de gasolina para cesped/
 Aparador de relva a gasolina

FPGTP25-2

3663602939979

The object of the declaration described above is in conformity with the relevant Union harmonisation legislation:

L'objet de la déclaration décrit ci-dessus est conforme à la législation d'harmonisation de l'Union applicable :

Wymieniony powyżej przedmiot niniejszej deklaracji jest zgodny z odnośnymi wymaganiami unijnego prawodawstwa harmonizacyjnego:

Obiectul declarației descris mai sus este în conformitate cu legislația relevantă de armonizare a Uniunii:

El objeto de la declaración descrita anteriormente es conforme con la legislación de armonización pertinente de la Unión:

O objeto da declaração acima descrito está em conformidade com a legislação de harmonização da União aplicável:

2006/42/EC as amended Machinery Directive
 2014/30/EU as amended Directive Electromagnetic compatibility
 2000/14/EC as amended Outdoor Noise Directive
 2016/1628/EU Regulation Gaseous and Particulate Pollutant Emission Limits
 2011/65/EU as amended Directive Restriction of the use of certain hazardous substances in electrical and electronic equipment
 2006/42/CE telle que modifiée Directive sur les machines
 2014/30/UE telle que modifiée Directive Compatibilité électromagnétique
 2000/14/CE telle que modifiée Directive relative aux émissions sonores dans l'environnement des matériels destinés à être utilisés à l'extérieur des bâtiments
 2016/1628/UE Règlement relatif aux exigences concernant les limites d'émission pour les gaz polluants et les particules polluantes
 2011/65/UE telle que modifiée Directive relative à la limitation de l'utilisation de certaines substances dangereuses dans les équipements électriques et électroniques
 2006/42/WE w zmienionej dyrektywie maszynowej
 2014/30 / UE ze zmianami Dyrektywa Kompatybilność elektromagnetyczna
 2000/14/WE w zmienionej dyrektywie w sprawie hałasu na zewnątrz
 2016/1628/UE limity emisji zanieczyszczeń gazowych i cząstek stałych
 2011/65 / UE ze zmianami Dyrektywa Ograniczenie stosowania niektórych niebezpiecznych substancji w sprzęcie elektrycznym i elektronicznym
 2006/42/CE, astfel a fost modificată Directiva privind echipamentele
 2014/30/UE, astfel a fost modificată Directiva privind compatibilitatea electromagnetică
 2000/14/CE, astfel a fost modificată Directiva privind zgomotul în aer liber
 2016/1628/UE Regulamentul privind emisiile de poluanți gazoși și de particule poluante
 2011/65/UE, astfel a fost modificată Directiva privind limitarea utilizării anumitor substanțe periculoase în echipamentele electrice și electronice
 Directiva sobre maquinaria modificada 2006/42/CE
 2014/30/UE modificada Directiva Compatibilidad electromagnética
 2000/14/CE modificada Directiva sobre ruido al aire libre
 2016/1628/Reglamento de la UE Límites de emisiones de contaminantes gaseosos y partículas
 2011/65/UE modificada Directiva Restricción del uso de determinadas sustancias peligrosas en equipos eléctricos y electrónicos
 2006/42/CE como diretiva de máquinas alteradas
 2014/30/UE como alteração da compatibilidade eletromagnética
 2000/14/CE como diretiva de ruído exterior alterada
 Limites de emissão de poluentes gasosos e de poluentes de partículas 2016/1628/REGULAMENTO da UE
 2011/65/UE como restrição diretiva alterada da utilização de certas substâncias perigosas em equipamentos elétricos e eletrônicos

Measured Sound Power Level

Le niveau de puissance acoustique mesuré

Zmierzony poziom mocy akustycznej

Nivel de putereacustică măsurat / Nivel de putereacustică garantat

Nível de potencia sonora medido

Nível de potência sonora medido

: 109.3 dB(A)

Engine Model

Modèle de moteur

Model silnika

Modelul motorului

Modelo de motor

Modelo de motor

: SL33

Guaranteed Sound Power Level

Le niveau de puissance acoustique garant

Gwarantowany poziom mocy akustycznej

Nível de potencia sonora garantizado

Nível de potência sonora garantido

: 111 dB(A)

References to the relevant harmonised standards used or references to the other technical specifications in relation to which conformity is declared:

Références des normes harmonisées pertinentes appliquées, y compris la date de celles-ci, ou des autres caractéristiques techniques, y compris la date de celles-ci, par rapport auxquelles la conformité est déclarée:

Odwolania do odnośnych norm zharmonizowanych, które zastosowano, wraz z datą normy, lub do innych specyfikacji technicznych, wraz z datą specyfikacji, w odniesieniu do których deklarowana jest zgodność:

Trimiteri la standardele armonizate relevante folosite, inclusiv data standardului, sau trimiteri la celelalte specificații tehnice, inclusiv data specificațiilor, în legătură cu care se declară conformitatea:

Referencias a las normas armonizadas pertinentes utilizadas, incluidas las fechas de las normas, o referencias a las otras especificaciones técnicas, incluidas las fechas de las especificaciones, respecto a las cuales se declara la conformidad:

Referências às normas harmonizadas aplicáveis utilizadas, incluindo a data da norma, ou às outras especificações técnicas, incluindo a data da especificação, em relação às quais é declarada a conformidade:

EN ISO 11806-1:2011

EN ISO 14982:2009

EN ISO 3744:1995

Authorised signatory and technical file holder/signataire et responsable de la documentation technique autorisé/podmiot uprawniony do wystawienia i adre sprezechowywania dokumentacji technicznej/semnatar autorizat și deținător al dosarului tehnic/firmante autorizado y titular del expediente técnico/signatário autorizado e detentor da ficha técnica

Kingfisher International Products B.V.,

Rapenburgerstraat 175E,

1011 VM Amsterdam,

The Netherlands



David Awe
Group Quality Director

:28/07/2021

**UK
CA**
(UK) DECLARATION OF CONFORMITY

Product

- Petrol grass trimmer
- FPGTP25-2
- 25 cm³ , 0.8 kW
- 000001 - 999999

Name and address of the manufacturer or his authorised representative:

Kingfisher International Products Limited
3 Sheldon Square
London W2 6PX
United Kingdom

This declaration of conformity is issued under the sole responsibility of the manufacturer.

Object of the declaration

Product	Model	EAN
Petrol grass trimmer	FPGTP25-2	3663602939979

The object of the declaration described above is in conformity with the relevant legislation:

Supply of Machinery (Safety) Regulations 2008 as amended
Noise Emission in the Environment by Equipment for Use Outdoors Regulations 2001 as amended
The Non-Road Mobile Machinery (Type-Approval and Emission of Gaseous and Particulate Pollutants) Regulations 2018 as amended
Electromagnetic Compatibility Regulations 2016 as amended
The Restriction of the use of Certain Hazardous Substances in Electrical and Electronic Equipment Regulations 2012 as amended

Measured Sound Power Level: 109.3 dB(A)

Guaranteed Sound Power Level: 111 dB(A)

Engine Model: SL33

References to the relevant designated standards used or references to the other technical specifications in relation to which conformity is declared:

EN ISO 11806-1:2011
EN ISO 14982:2009
EN ISO 3744:1995

Authorised signatory and technical file holder:

Kingfisher International Products Limited
3 Sheldon Square
London W2 6PX
United Kingdom



David Awe
Group Quality Director

On: **28/07/2021**

In more detail...



**Manufacturer, Fabricant, Prodecnt,
Producător, Fabricante:**

UK Manufacturer:

Kingfisher International Products Limited
3 Sheldon Square London W2 6PX
United Kingdom

EU Manufacturer:

Kingfisher International Products B.V.
Rapenburgerstraat 175E 1011 VM Amsterdam
The Netherlands



www.diy.com
www.screwfix.com
www.screwfix.ie

To view instruction manuals online,
visit www.kingfisher.com/products